

## Custom Sizes Form

Please refer to this blank drawing and fill out the sizes you measure. The most important sizes are the cutterblock's diameter without blades (D1), the diameter with the blades (D), the model numbers of the bearings, the taper if it has, and the threads. If you need any assistance, be free to contact us by email at [sales@sheartak.com](mailto:sales@sheartak.com).

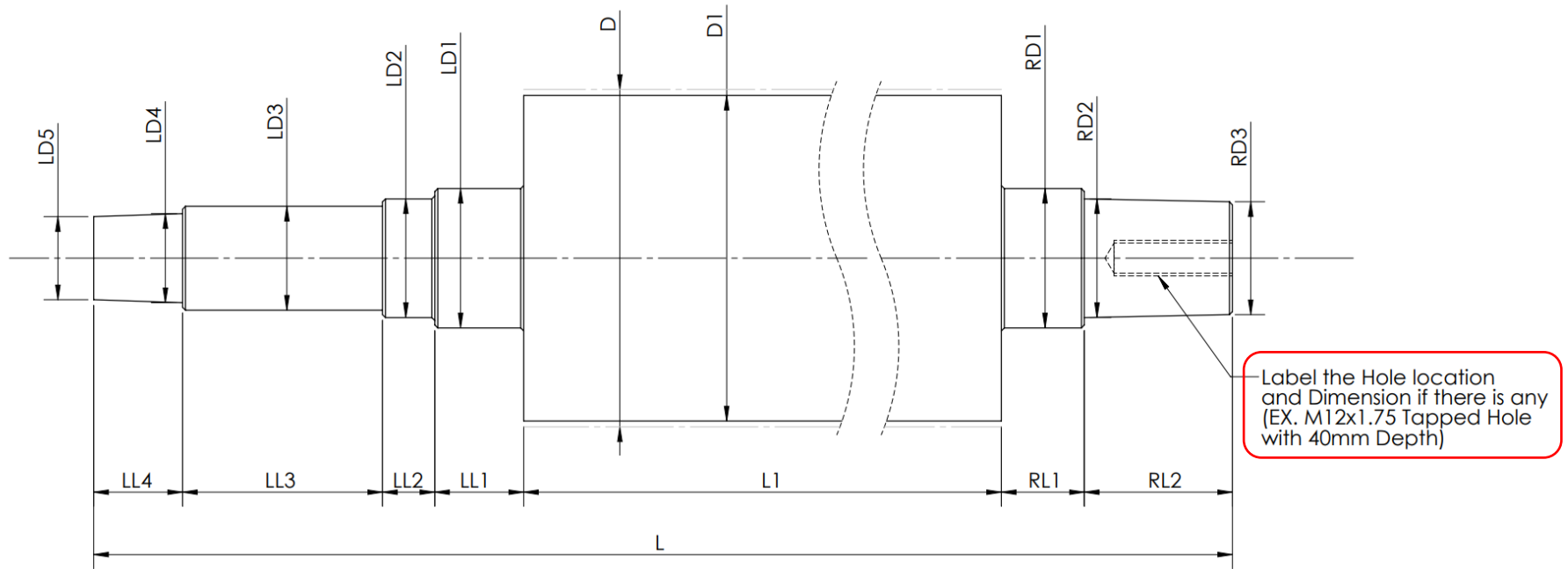

D (diameter of the block with the blade): \_\_\_\_\_ D1 (diameter of the block): \_\_\_\_\_ L (optional): \_\_\_\_\_

L1: \_\_\_\_\_ LL1: \_\_\_\_\_ LL2: \_\_\_\_\_ LL3: \_\_\_\_\_ LL4: \_\_\_\_\_

LD1: \_\_\_\_\_ LD2: \_\_\_\_\_ LD3: \_\_\_\_\_ LD4: \_\_\_\_\_ LD5: \_\_\_\_\_

RL1: \_\_\_\_\_ RL2: \_\_\_\_\_ RD1: \_\_\_\_\_ RD2: \_\_\_\_\_ RD3: \_\_\_\_\_

Other (ex. key slot, thread, etc.): \_\_\_\_\_

Brand Name: \_\_\_\_\_ Jointer: \_\_\_\_\_ Company Name: \_\_\_\_\_ Phone: \_\_\_\_\_

Model No. : \_\_\_\_\_ Planer: \_\_\_\_\_ Contact Person: \_\_\_\_\_ Fax: \_\_\_\_\_

Series No. : \_\_\_\_\_ Combo: \_\_\_\_\_ Email: \_\_\_\_\_

## Measuring Guide:

To ensure accurate measurements and confirm compatibility, some disassembly may be necessary to assess the necessary details. Please examine the reference drawing provided to identify the distinguishing features that are easiest to measure on your machine.

A standard caliper is sufficient for most measurements. For longer lengths, utilize a standard tape measure. Precision to the nearest 0.02mm or 0.001" is unnecessary.

Make notes of your measurements on the reference drawing. Ensure to check all critical dimensions listed below to confirm compatibility:

a) Overall Length

b) Cutting Circle with blades on.

(Kindly adhere to the instructions outlined in the following link: <https://www.sheartak.com/measure-cutting-circle>)

Blades commonly extend between 1mm to 3mm above the cutterhead body. However, it's crucial to ensure they are correctly adjusted according to your machine's specifications before taking measurements. For jointers equipped with fixed outfeed tables, precise alignment is essential to prevent snips at the ends of the board.

c) Cutterhead body length (central part).

d) Bearing sizes or numbers on the sides.

e) Shaft diameter for pulley.

f) Keyway size

If you have any questions or uncertainty, call us at 1-877-417-4327 or contact us at [sales@sheartak.com](mailto:sales@sheartak.com).